





13 801 670

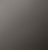

- sporgenza 200 mm
- Getto normale squadrato
- diametro foro 37 mm
- ingresso 1/2"
- portata max 25,1 l/min a una pressione idraulica di 3 bar

|   |                         |               |
|---|-------------------------|---------------|
|  | Cromato                 | 13 801 670-00 |
|  | Platinato<br>spazzolato | 13 801 670-06 |
|  | Dark Chrome             | 13 801 670-19 |
|  | Nero opaco              | 13 801 670-33 |
|  | Cromo spazzolato        | 13 801 670-93 |

**Prodotti complementari**



- raccordo angolare ad incasso - 35 085 970 90**
- Profondità d'incasso max. 163 mm
  - profondità d'incasso min. 90 mm

13 801 670

mm [inches]

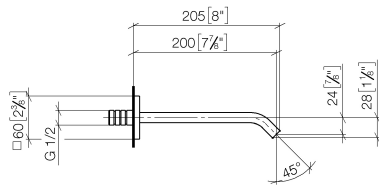

### Diagramma di portata

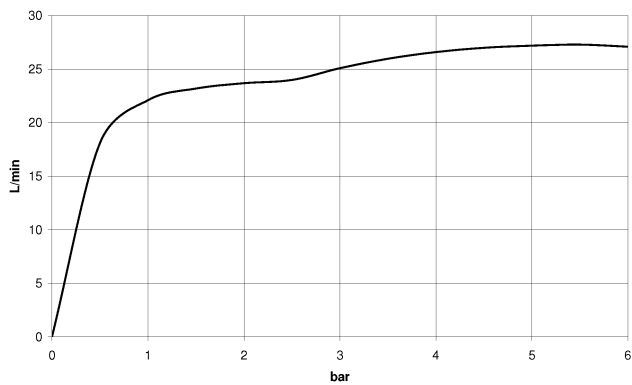

### Certificati

IAPMO\_4976 (6). WRAS\_2005002.

13 801 670

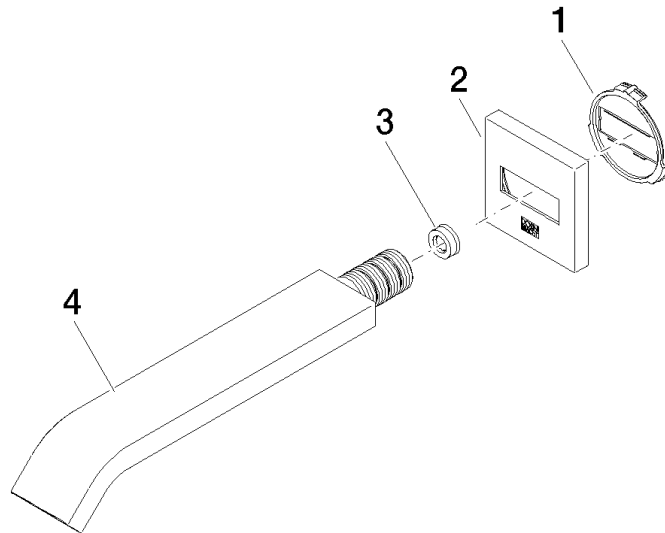

### Elenco delle parti di ricambio

| N. | Codice articolo    | Denominazione         | Quantità necessaria | Tempo di produzione |
|----|--------------------|-----------------------|---------------------|---------------------|
| 1  | 09 18 40 139 90    | alloggio              | 1                   | 2                   |
| 2  | 09 27 67 008-00    | rosetta               | 1                   | 10                  |
| 3  | 09 23 01 057 90    | limitatore di portata | 1                   | 2                   |
| 4  | 04 28 22 241 00-00 | bocca di erogazione   | 1                   | 10                  |